



ARIES MARINE CORPORATION

RAM VIII, RAM X and RAM XI Liftboat Class 175

Dimensions

Length Overall	113'
Length (Barge Only)	98'
Beam Overall	70'
Beam (Barge Only)	40'
Depth (Barge Only)	9'
Design Draft	9'5"
Open Deck Area	3,600 sq. ft.

Crane (Nautilus) Hydraulic & Propulsion

Capacity	10 & 70 Ton
Boom Length (10 Ton)	Fixed 60'
Boom Length (70 Ton)	Fixed 100'
Main Engines	Two (2) 12V-92T Detroit Diesel
Rated Ship	Approx 900
Reduction Gear	Twin Disc

Hull Characteristics & Legs

Gross Tonnage	168
Net Tonnage	134
Max Deck Cargo	400,000#
Number of Legs	3
Length	175'
Size	54" diameter
Wall Thickness	3/4" (braced inside)

Generators & Capacities

Engines	Two (2) 6-71 Detroit Diesel
Generator	Two (2) 75kw
Fuel	Approx. 7,500 Gallons
Potable Water	Approx. 15,000 Gallon



Pads & Jacking System

Length	26'
Width	14'
Depth	26'
Configuration	Raked on Both Ends
Max. Working Water Depth	130'
Max Sea Conditions(Jacking)	5'

Estimated Speed

Eight (8) Knots

Electronics

VHF
SSB
Fathometer
Tilt Alarm
GPS
Loud Hailer
Radar
DSS TV

Available Berths (excluding crew) 22

Class 175' Self-Elevating M/V Ram VIII, Ram X, Ram XI

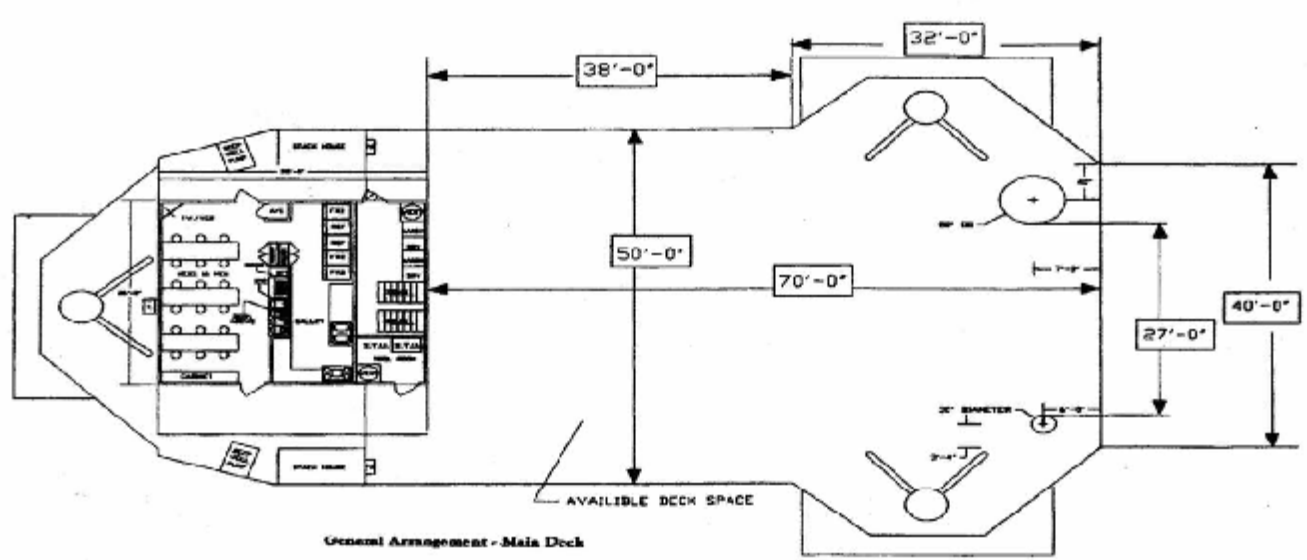
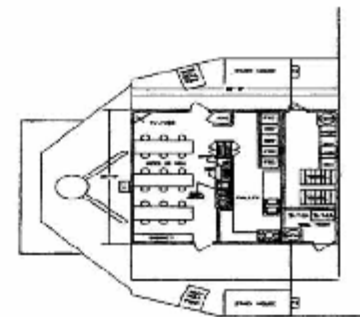

General Arrangement - Main Deck

CLASS 175'

LIFTING LOAD CAPACITY CHART NAUTILUS MODEL - 354B4

LIFTING LOAD CAPACITY CHART NAUTILUS MODEL - 340L

60' BOOM CRANE

100' BOOM CRANE

		MAIN HOIST				MAIN HOIST	
RADIUS (FT)	BOOM ANGLE (DEG)	4- PART REEVING		RADIUS (ft)	BOOM ANGLE (deg)	4- PART REEVING	
		STATIC (LB)	DYNAMIC (LB)			Static (LB)	Dynamic (LB)
10	80	17,660	11,640	21	81	139,812	92,275
15	76	16,595	10,930	25	78	115,078	75,785
20	71	15,556	10,237	30	75	95,115	62,477
25	68	13,443	8,829	35	73	80,613	52,809
30	61	10,970	7,180	40	70	69,600	45,467
35	55	9,218	6,012	45	66	60,950	39,700
40	49	7,911	5,141	50	63	53,975	35,050
45	42	6,899	4,466	55	60	48,230	31,220
50	35	6,092	3,928	60	57	43,415	28,010
55	25	5,433	3,489	65	53	39,320	25,280
60	0	3,795	2,397	70	49	35,794	22,929
				75	46	32,725	20,883
				80	41	30,028	19,085
				85	37	27,639	17,493
				90	32	25,508	16,071
				95	26	23,588	14,792
				100	18	21,848	13,632
				105	0	20,228	12,552